

## PIPING COMPONENTS

For whole piping component, we also supply gas collection pipes, flanges, forged pies



**Cangzhou Longtaidi  
Pipe Technology Co., Ltd.**

### Headquarter:

**Factory:** No.33 Huanghe East Road,  
Economic Development Zone, Cangzhou, China  
Telephone: +86-317-2035788 • Fax +86-317-2035788

Mail: Pipes2018@163.com

### Beijing Office:

RM1703, NO.3 Building, 317 Datun Road,  
Chaoyang District Beijing, China  
Telephone: Mail: Pipes2018@ltdpipeline.com

### Iranian Office:

6th Floor, No.6 Taban Sharghi Alley, Alborz  
Telephone:  
Mail: pipes2018@ltdpipeline.com

### Dubai Branch:

**Longtic International Trading FZE**  
Add: No.1910 Icon Tower Two,  
Jumeirah Lakes Tower, Dubai. U.A.E  
Telephone: P.O. Box No.:262855 • Mail: Pipes2018@  
163.com

### USA Branch:

**Lontide America LLC**  
PO BOX 941785 Houston, TX 77094, USA  
Telephone:  
Mail: Pipes2018@163.com

[www.ltdpipeline.com](http://www.ltdpipeline.com)



Specialization | Quality | Honesty

Cangzhou Longtaidi Pipe Technology Co., Ltd



Mechanical Lined Pipe



Induction Pipe Bends



Clad Pipes and Clad Pipe Fittings



Pipe



Pipe Fittings (Large Diameter)



## INTRODUCTION

We specialize in the production of pipe fittings, including large diameter and corrosion resistant (NACE). Our advantage is in part due to our world class production and testing equipment. This in combination with our skilled workforce, rich in manufacturing experience has resulted in significant growth over recent years.

Our products range to 3200 mm OD, with a maximum WT of 150 mm, and PN up to 42 Mpa. Typical manufacturing materials include; stainless, alloy and carbon steels, bimetal clad, nickel and inconel alloys. Other materials are available to meet your exact needs.

In addition, we have established long term relationships with many domestic research institutes, ensuring we are always at the leading edge of product development. We also continuously invest in better physical and chemical testing. The results of our methods are evident in our quality, product quality is our life.

Each fitting is fully traceable and conforms to ASTM, ASME, MSS or other manufacturing and quality standards per order requirement.

## PROCESS



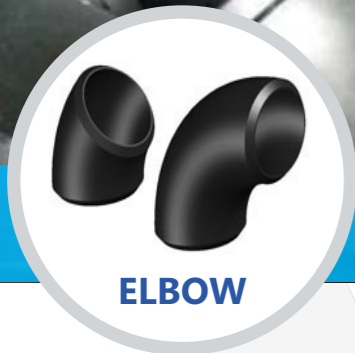

**ELBOW**

**Dimensions Butt Weld Elbows 45°-90° LR & 3D, Elbows 90°-SR, 180° LR & SR according to ASME B16.9**

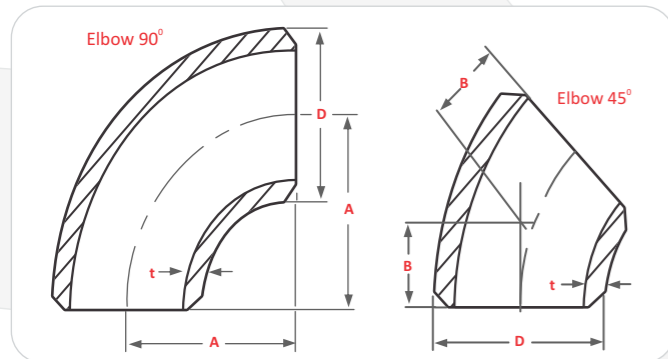

NPS	O.D. D	90° Long Radius Center-to-End A	45° Long Radius Center-to-End B	90° 3D Center-to-End A	45° 3D Center-to-End B
8	219.1	305	127	610	252
10	273	381	159	762	316
12	323.8	457	190	914	378
14	355.6	533	222	1067	441
16	406.4	610	254	1219	505
18	457	686	286	1372	568
20	508	762	318	1524	632
22	559	838	343	1676	694
24	610	914	381	1829	757
26	660	991	406	1981	821
28	711	1067	438	2134	883
30	762	1143	470	2286	964
32	813	1219	502	2438	1010
34	864	1295	533	2591	1073
36	914	1372	565	2743	1135
38	965	1448	600	2896	1200
40	1016	1524	632	3048	1264
42	1067	1600	660	3200	1326
44	1118	1676	695	3353	1389
46	1168	1753	727	3505	1453
48	1219	1829	759	3658	1516
etc.					

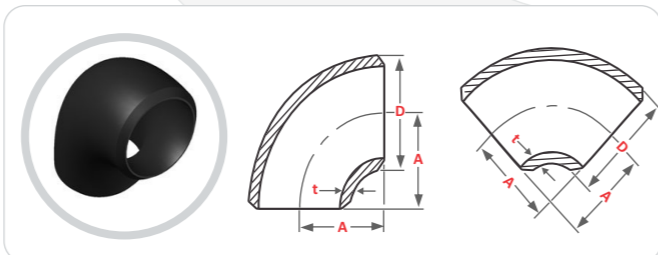

**TEE**

**Dimensions butt welded Straight Tees - ASME B16.9 - NPS 8 - 48**

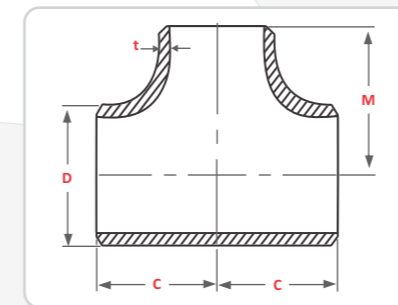

NPS	O.D. D	Center to End C	Center to End M
8	219.1	178	178
10	273	216	216
12	323.8	254	254
14	355.6	279	279
16	406.4	305	305
18	457	343	343
20	508	381	381
22	559	419	419
24	610	432	432
26	660	495	495
28	711	521	521
30	762	559	559
32	813	597	597
34	864	635	635
36	914	673	673
38	965	711	711
40	1016	749	749
42	1067	762	711
44	1118	813	762
46	1168	851	800
48	1219	889	838
etc.			

**Dimensions butt welded Reducing Tees - ASME B16.9- NPS 8- 48**

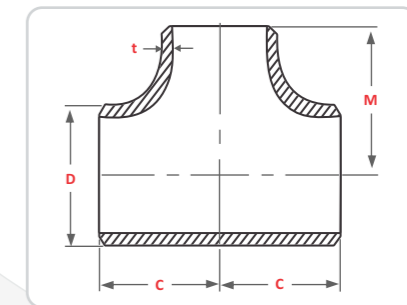

NPS	O.D. D	O.D. D1	Center to End C	Center to End M
8 - 3½	219.1	101.6	178	152
10-4	273	114.3	216	184
12-5	323.8	141.3	254	216
14-6	355.6	168.3	279	238
16-6	406.4	168.3	305	264
18-8	457	219.1	343	298
20-8	508	219.1	381	324
22-10	559	273	419	359
24-10	610	273	432	384
26-12	660	323.8	495	422
28-12	711	323.8	521	448
30-10	762	273	559	460
32 - 14	813	355.6	597	508
34 - 16	864	406.4	635	533
36 - 16	914	406.4	673	559
38 - 18	965	457	711	597
40 - 18	1016	457	749	622
42 - 16	1067	406.4	762	635
44 - 20	1118	508	813	686
46 - 22	1168	559	851	724
48 - 22	1219	559	889	737
etc.				

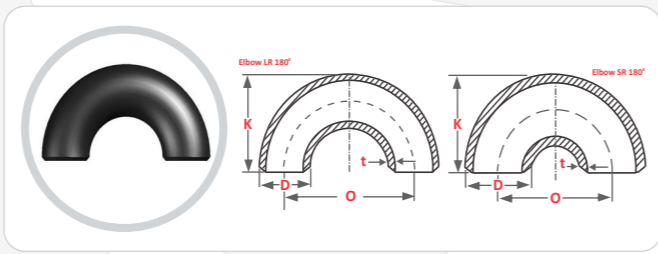

NPS	O.D. D	180° Long Radius		180° Short Radius	
		Center to Center O	Back to Face K	Center to Center O	Back to Face K
8	219.1	610	414	406	313
10	273	762	518	508	391
12	323.8	914	619	610	467
14	355.6	1067	711	711	533
16	406.4	1219	813	813	610
18	457	1372	914	914	686
20	508	1524	1016	1016	762
22	559	1676	1118	1118	838
24	610	1829	1219	1219	914
-	-	-	-	-	-
etc.					



**Dimensions Butt Weld Reducers  
Con & Ecc ASME B16.9**

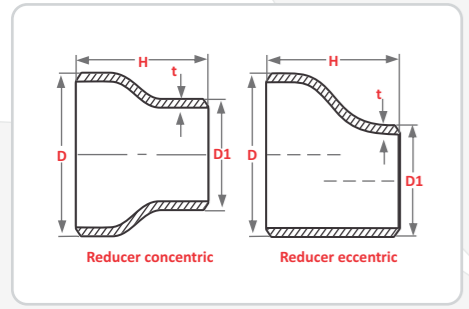

NPS	O.D. D	O.D. D1	Length H
8 - 3½	219.1	101.6	152
8-4	219.1	114.3	152
8-5	219.1	141.3	152
8-6	219.1	168.3	152
10-4	273	114.3	178
10-5	273	141.3	178
10-6	273	168.3	178
10-8	273	219.1	178
12-5	323.9	141.3	203
12-6	323.9	168.3	203
12-8	323.9	219.1	203
12-10	323.9	273	203
14-6	355.6	168.3	330
14-8	355.6	219.1	330
14-10	355.6	273	330
14-12	355.6	323.9	330
16-8	406.4	219	356
16-10	406.4	273	356
16-12	406.4	323.9	356
16 - 14	406.4	355.6	356
18-10	457	273	381
18-12	457	323.9	381
18 - 14	457	355.6	381
18 - 16	457	406.4	381

NPS	O.D. D	O.D. D1	Length H
20-12	508	323.9	508
20 - 14	508	355.6	508
20 - 16	508	406.4	508
20 - 18	508	457	508
22 - 14	559	355.6	508
22 - 16	559	406.4	508
22 - 18	559	457	508
22 - 20	559	508	508
24 - 16	610	406.4	508
24 - 18	610	457	508
24 - 20	610	508	508
24 - 22	610	559	508
26 - 18	660	457	610
26 - 20	660	508	610
26 - 22	660	559	610
26 - 24	660	610	610
28 - 18	711	457	610
28 - 20	711	508	610
28 - 24	711	610	610
28 - 26	711	660	610
30 - 20	762	508	610
30 - 24	762	610	610
30 - 26	762	660	610
30 - 28	762	711	610
32 - 24	813	610	610
32 - 26	813	660	610
32 - 28	813	711	610
32 - 30	813	762	610
34 - 24	864	610	610
34 - 26	864	660	610
34 - 30	864	762	610
34 - 32	864	813	610
36 - 24	914	610	610
36 - 26	914	660	610

NPS	O.D. D	O.D. D1	Length H
36 - 30	914	762	610
36 - 32	914	813	610
36 - 34	914	864	610
38 - 26	965	660	610
38 - 28	965	711	610
38 - 30	965	762	610
38 - 32	965	813	610
38 - 34	965	864	610
38 - 36	965	914	610
40 - 30	1016	762	610
40 - 32	1016	813	610
40 - 34	1016	864	610
40 - 36	1016	914	610
40 - 38	1016	965	610
42 - 30	1067	762	610
42 - 32	1067	813	610
42 - 34	1067	864	610
42 - 36	1067	914	610
42 - 38	1067	965	610
42 - 40	1067	1016	610
44 - 36	1118	914	610
44 - 38	1118	965	610
44 - 40	1118	1016	610
44 - 42	1118	1067	610
46 - 38	1168	965	711
46 - 40	1168	1016	711
46 - 42	1168	1067	711
46 - 44	1168	1118	711
48 - 40	1219	1016	711
48 - 42	1219	1067	711
48 - 44	1219	1118	711
48 - 46	1219	1168	711

etc.



**Dimensions Butt Weld Caps  
NPS 1/2 - 48 ASME B16.9**

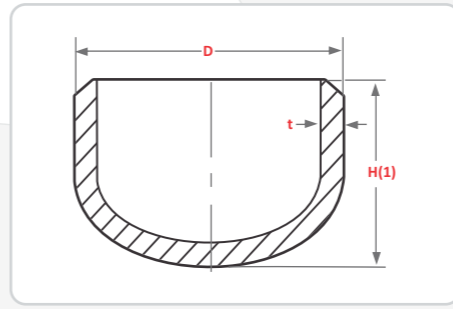

NPS	O.D. D	Length H	Wall Thickness T	Length H1
1/2	21.3	25	4.57	25
3/4	26.7	25	3.81	25
1	33.4	38	4.57	38
1.1/4	42.2	38	4.83	38
1.1/2	48.3	38	5.08	38
2	60.3	38	5.59	44
2.1/2	73	38	7.11	51
3	88.9	51	7.62	64
3.1/2	101.6	64	8.13	76
4	114.3	64	8.64	76
5	141.3	76	9.65	89
6	168.3	89	10.92	102
8	219.1	102	12.7	127
10	273	127	12.7	152

NPS	O.D. D	Length H	Wall Thickness T	Length H1
12	323.8	152	12.7	178
14	355.6	165	12.7	191
16	406.4	178	12.7	203
18	457	203	12.7	229
20	508	229	12.7	254
22	559	254	12.7	254
24	610	267	12.7	305
26	660	267	-	-
28	711	267	-	-
30	762	267	-	-
32	813	267	-	-
34	864	237	-	-

etc.

**General notes:**

Dimensions are in millimeters unless otherwise indicated.

Wall thickness (t) must be specified by customer.

The shape shall be ellipsoidal and shall conform to the requirements given in the ASME Boiler and Pressure Vessel Code.

Length (H) applies for thickness not exceeding that given in column "Wall Thickness" for Length, H. Length (H1) applies for thickness greater than that given in column "Wall Thickness" for NPS 24 and smaller.

For NPS 26 and larger, length H1 shall be by agreement between the manufacturer and purchaser.